

INSTALLATION INSTRUCTIONS

TUNDRA CUSTOM MOUNTING KIT

2000 & NEWER (STANDARD CAB LONG BOX ONLY)

DEALER/INSTALLER:

- (1) Provide this Manual to end user.
- (2) Physically demonstrate procedures in this Manual to end user.
- (3) Have end user demonstrate that he/she understands procedures.

END USER:

- (1) Read and follow this Manual every time you use Hitch.
- (2) Save this Manual for future reference.
- (3) Pass on copies of Manual to any other user or owner of Hitch.

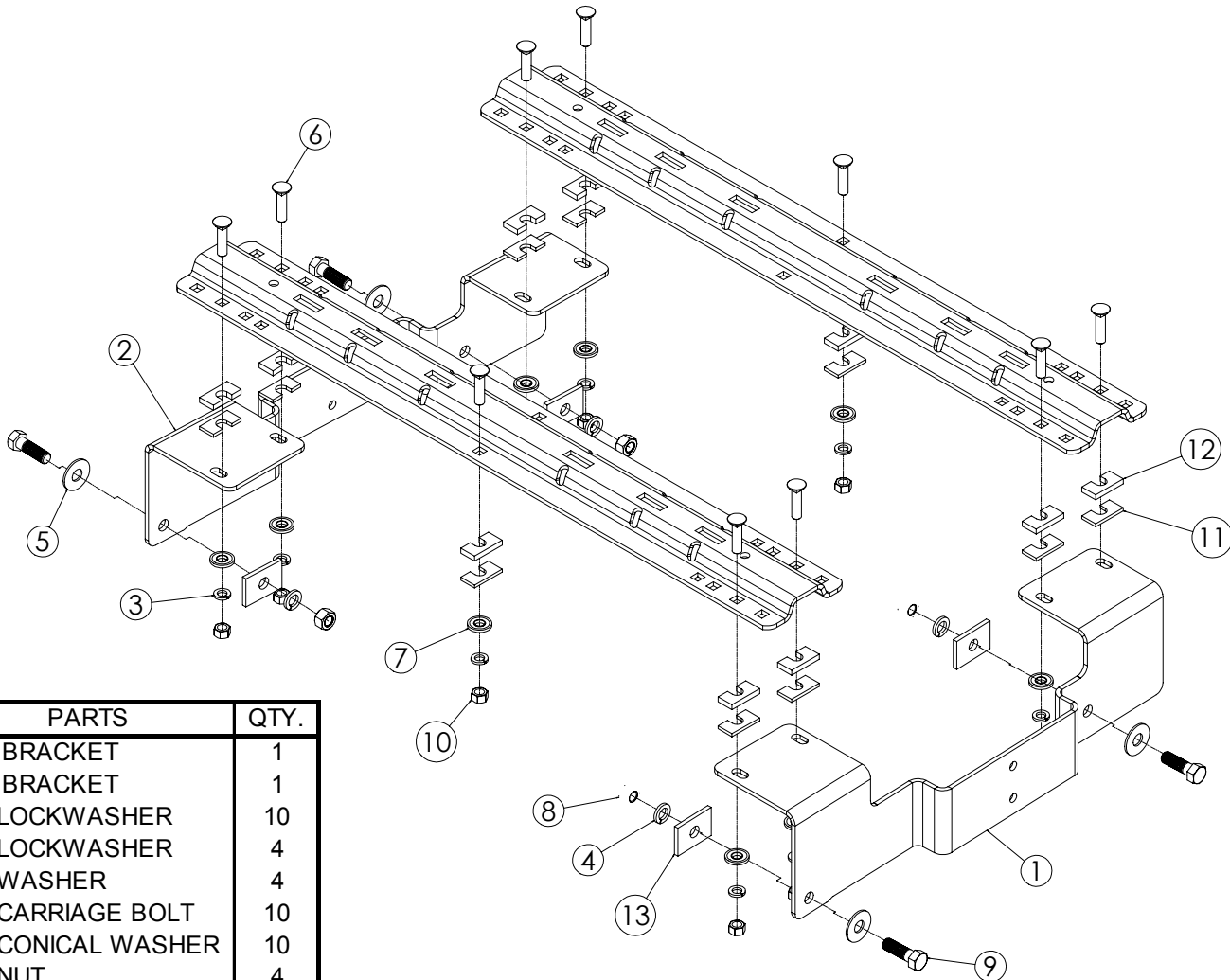

Fig. 1

	PARTS	QTY.
1	D.S. BRACKET	1
2	P.S. BRACKET	1
3	1/2" LOCKWASHER	10
4	5/8" LOCKWASHER	4
5	5/8" WASHER	4
6	1/2" CARRIAGE BOLT	10
7	1/2" CONICAL WASHER	10
8	5/8" NUT	4
9	5/8" HEX HD. BOLT	4
10	1/2" HEX NUT	10
11	3/16" FILLER SPACER	10
12	5/16" FILLER SPACER	10
13	1/4" SPACER	4

For Installation Assistance or Technical Help, Call 1-888-521-0510

TOOLS



- | | |
|--------------|--|
| 3/16" drill | 3/4" & 15/16" Socket & Open End Wrench |
| 17/32" drill | 100 & 200 lb-ft Torque Wrench |

1. The following instructions should be used to mount the 5th wheel. Care and attention to detail will ensure a quick quality installation. Check parts against parts list to become familiar with parts in kit. (See Fig. 1)
2. Raise rear of truck high enough to allow jack stands to be placed under rear spring hanger bracket of truck. This will provide maximum room to install the 5th wheel brackets.

 **WARNING:**

If the truck is raised, be sure that the truck is properly blocked and restrained to prevent the truck from falling. Failure to do so may result in the truck suddenly falling, causing death or serious injury.



3. Do not install mounting rails over plastic bed liners. Plastic bed liners must be cut out of the way. Base rails may be installed on spray in liner. **Note:** Consult installer for recommended curing time.
4. Use only TOWING PRODUCTS supplied bolts, nuts, and washers to install this kit. All 1/2" hardware is grade 5 and 5/8" hardware is grade 8 unless specified otherwise.

 **CAUTION:** 

These instructions are guidelines only. Actual installation is the responsibility of the installer and the owner. Always measure truck and trailer before installing hitch to be sure that there is clearance at the cab and at the bumper to allow for turns.

To prevent the trailer from hitting the cab with the trailer turned 90°, the center of the hitch should be at least 52" from the back of the cab when using a long bed truck. (Actual distance required will depend on trailer width and king pin location.)

5. Measurements are given from Rear Edge of truck bed to rear edge of the base rail closest to the Rear Edge of truck for most vehicle applications (See Fig. 3).
6. Center hitch between fender wells and make sure rails are square. Adjust position of rails until both diagonal measurements are the same. This should allow installation of a gooseneck or other 5th wheels to these rails (See Fig. 2).

 **CAUTION:** 

Check for obstructions before drilling. Failure to do so could result in damaged fuel or brake lines, structural members, etc. TOWING PRODUCTS does its best to communicate tow vehicle manufacturer changes; however, it is ultimately the responsibility of the installer to prevent damage due to installation.

7. Drill 10 holes identified in Fig. 2. Drill all holes with 3/16" drill and enlarge them with a 17/32" drill. Always use sharp drill bits. A 3/16" pilot hole will greatly speed drilling larger holes. Install 1/2" carriage bolts into holes. Install 3/16" & 5/16" thick slotted spacer above or below bed to fill corrugations in bed floor.
8. Install mounting brackets onto carriage bolts. Secure bolts through mounting brackets with serrated washers, lock washers, and hex nuts. Secure the other two bolts through the bed with flat washers, lock washers, and nuts.

For Installation Assistance or Technical Help, Call 1-888-521-0510

9. Install side plates to frame with four 5/8"-11x2" hex. head bolts with flat washer, (threads pointing inward), 1/4" spacer, lock washers, and hex nuts through existing holes in frame. (See Fig. 1 & 3)

Note: On vehicles with heavy duty suspensions, check for interference with bolts where brackets are mounted to frame. If interference with suspension spring results, cut bolt flush to nut outboard of frame or use weld option.

⚠ WARNING:
DO NOT lubricate threads. It may cause bolt failure.

⚠ CAUTION: ⚠
Check for obstructions before drilling. Failure to do so could result in damaged fuel or brake lines, structural members, etc. TOWING PRODUCTS does its best to communicate tow vehicle manufacturer changes; however, it is ultimately the responsibility of the installer to prevent damage due to installation.

10. Torque all 1/2" nuts to 85 lb-ft. & 5/8" nuts to 170 lb-ft.

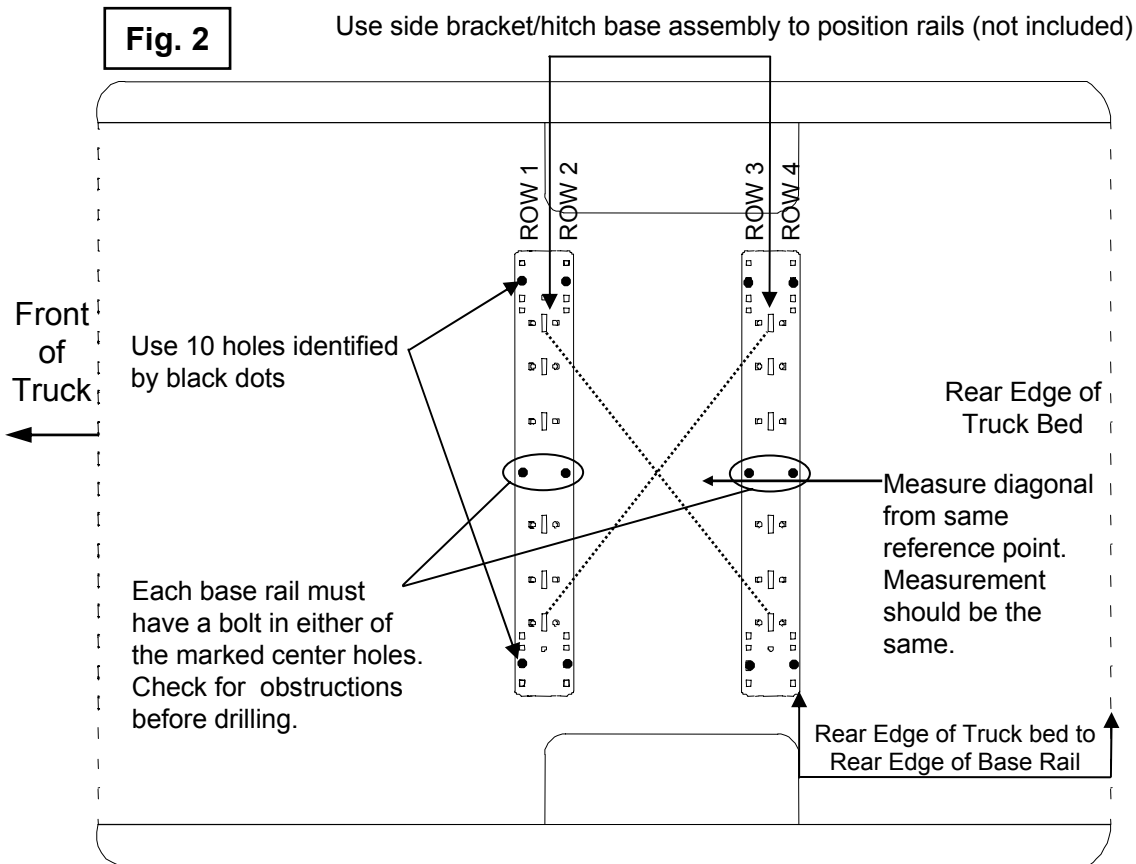

TOYOTA TUNDRA 2000 & NEWER (STANDARD CAB LONG BOX ONLY)

CAUTION!

Read pages 2-3 of these instructions before starting installation. Failure to do so could result in significant vehicle damage!

Fig. 3

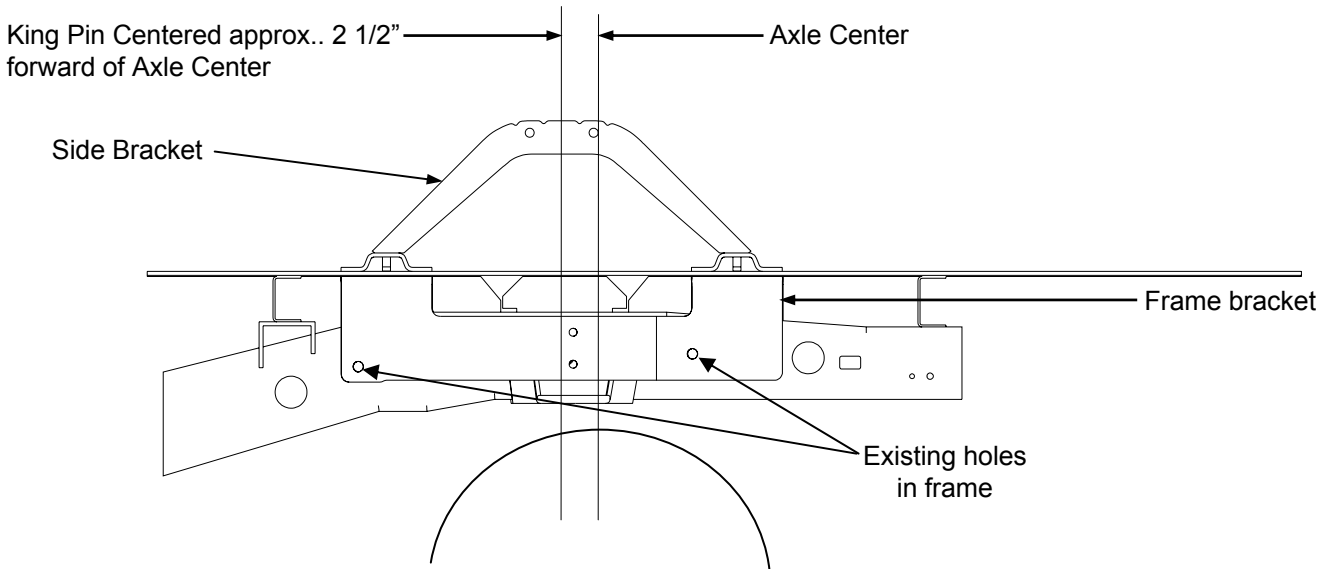
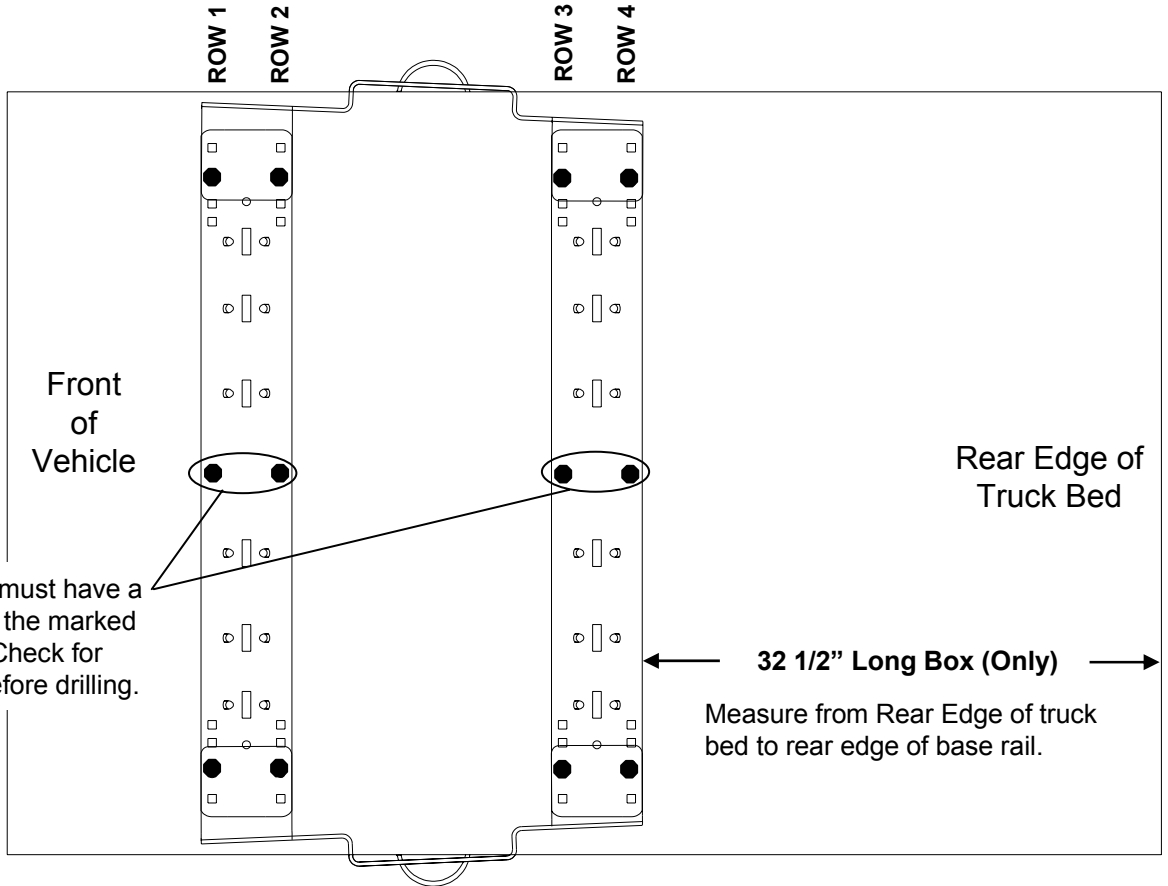

CAUTION!

Check for obstructions before drilling. Failure to do so could result in damaged fuel or brake lines, structural members, etc. TOWING PRODUCTS does its best to communicate tow vehicle manufacturer changes; however, it is ultimately the responsibility of the installer to prevent damage due to installation.

NOTES

FIVE YEAR LIMITED WARRANTY

TOWING PRODUCTS warrants its 5th Wheel Hitch Mounting Kits from date of purchase against defects in material and workmanship under normal use and service, ordinary wear and tear excepted, for 5 years of ownership to the original consumer purchaser when a TOWING PRODUCTS mounting kit is used.

TOWING PRODUCTS will replace FREE OF CHARGE any part which proves defective in material or workmanship when presented to any TOWING PRODUCTS dealer, TOWING PRODUCTS Warehouse or returned to factory. TRANSPORTATION CHARGES PREPAID, at the address below. THIS WARRANTY IS LIMITED TO DEFECTIVE PARTS REPLACEMENT ONLY. LABOR CHARGES AND/OR DAMAGE INCURRED IN INSTALLATION OR REPLACEMENT AS WELL AS INCIDENTAL AND CONSEQUENTIAL DAMAGES CONNECTED THEREWITH ARE EXCLUDED.

Some states do not allow the exclusion or limitation of incidental or consequential damages, so the above limitation or exclusion may not apply to you.

Any damage to the 5th Wheel Hitch as a result of misuse, abuse, neglect, accident, improper installation, or any use violative of instructions furnished by us, WILL VOID THE WARRANTY.

This warranty gives you specific legal rights, and you may also have other rights which vary from state to state. In the event of a problem with warranty service or performance, you may be able to go to a small claims court, or a federal district court.

Towing Products, Inc.
47774 Anchor Ct.
Plymouth, MI. 48170