

INSTALLATION INSTRUCTIONS

EQUIPMENT REQUIRED: C-CLAMPS, HACKSAW

DRILL BITS: 9/16

WRENCHES: (TIGHTEN ALL FASTENERS WITH TORQUE WRENCH) 13/16, 7/8, 15/16

VEHICLE	HITCH NO.
MOTOR HOME HITCH KIT FOR FRAMES UP TO 46 INCHES OVERALL WIDTH	5350

DO NOT EXCEED LOWER OF
TOWING VEHICLE MFR'S RATINGS OR

HITCH TYPE ▼	MAX GROSS TRLR WT(LB)	MAX TONGUE WT(LB)
WEIGHT DISTRIBUTING	6000	750
WEIGHT CARRYING BALL MOUNT	5000	500

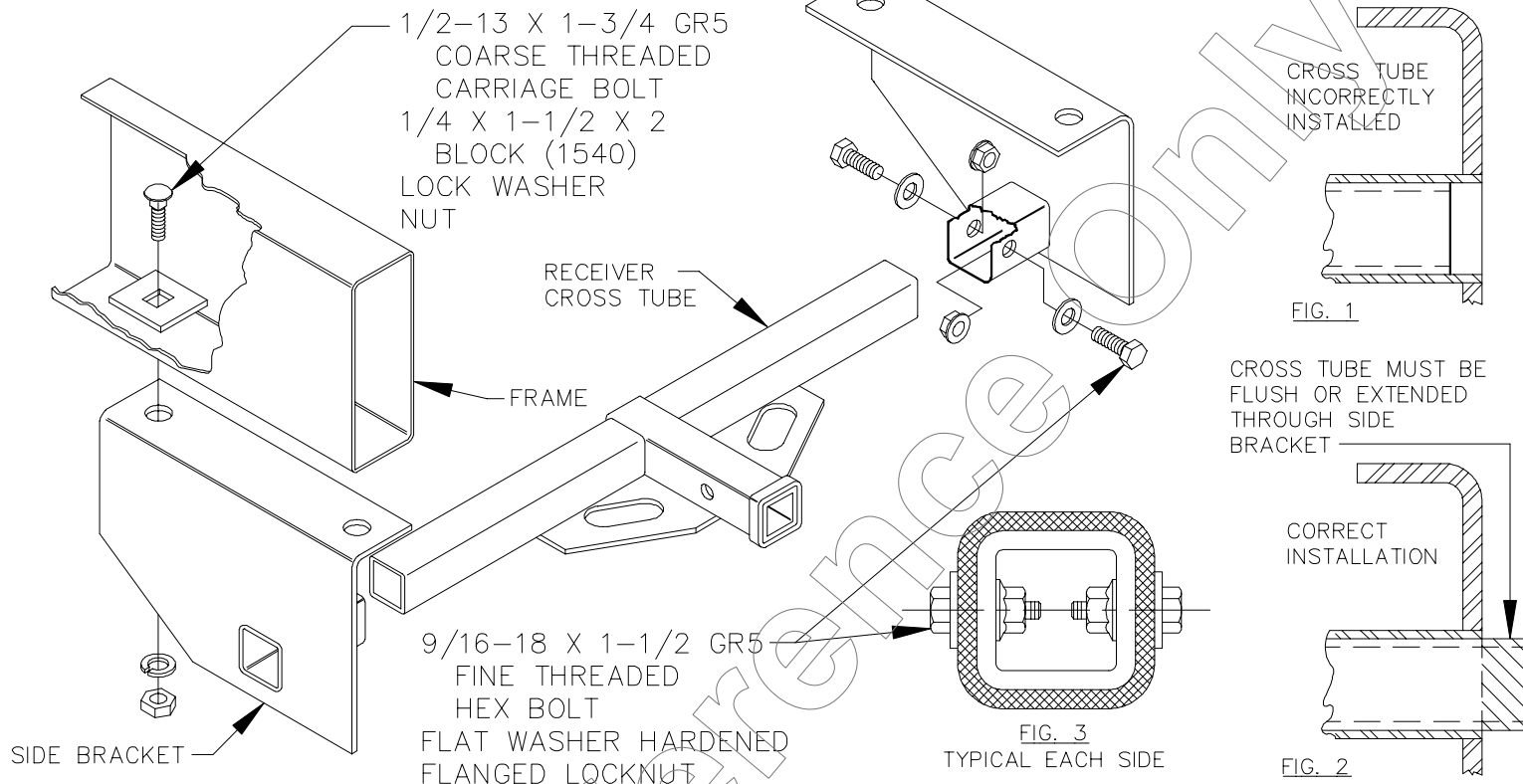

THIS IS A GENERAL APPLICATION PRODUCT AND IT IS THE RESPONSIBILITY OF THE INSTALLER TO SELECT A STRUCTURALLY SAFE LOCATION FOR ATTACHMENT.

1. SLIDE SIDE BRACKETS ONTO RECEIVER CROSS TUBE.
2. POSITION AND CLAMP SIDE BRACKETS TO BOTTOM OF FRAME SO THE RECEIVER TUBE WITH BALL MOUNT IS CENTERED ON VEHICLE AND THERE IS ADEQUATE COUPLER CLEARANCE.
3. USING SIDE BRACKETS AS TEMPLATE, DRILL TWO (2) HOLES INTO FRAME WITH 1/2 DRILL BIT.
4. INSTALL 1/2-13 X 1-3/4 GR5 COARSE THREADED CARRIAGE BOLTS AND BLOCKS INTO DRILLED HOLES IN FRAME AND SIDE BRACKETS. BOLTS AND BLOCKS MAY HAVE TO BE FISHWIRED OR BUMPER LOOSENED IF NO ACCESS HOLES ARE PRESENT FOR BOLT/BLOCK INSTALLATION. LOOSELY INSTALL LOCK WASHERS AND NUTS. REMOVE CLAMPS.
5. CENTER RECEIVER CROSS TUBE ON VEHICLE AND CLAMP AT BOTH ENDS TO PREVENT MOVEMENT WHILE DRILLING. USING THE TWO HOLES PER SIDE (TOTAL OF FOUR) IN THE SIDE BRACKET TUBES AS TEMPLATES, DRILL 9/16 DIAMETER HOLES THROUGH WALLS OF CROSS TUBE. INSTALL 9/16-18 X 1-1/2 FINE THREADED HEX BOLTS, FLAT WASHERS AND FLANGED LOCK NUTS AS SHOWN IN FIG. 3. REMOVE CLAMPS.
6. CROSS TUBE MAY BE TRIMMED FLUSH WITH OUTSIDE OF SIDE BRACKET. SEE FIG. 2.
NOTE: IF TRIMMED, COAT BARE METAL WITH PAINT TO PREVENT CORROSION.

TIGHTEN 1/2-13 GR5 COARSE THREADED CARRIAGE BOLTS TO 75 LB.-FT.

TIGHTEN 9/16-18 GR5 FINE THREADED HEX BOLTS TO 110 LB.-FT.

THIS PRODUCT COMPLIES WITH SAFETY SPECIFICATIONS AND REQUIREMENTS FOR CONNECTING DEVICES AND TOWING SYSTEMS OF THE STATE OF NEW YORK AND V.E.S.C. REGULATION V-5.

APPROX WEIGHT (LB.)	FASTENER KIT NO.
44.5	1130-881



Draw-Tite, Inc.
40500 Van Born Road
Canton, Michigan 48188

NOTE: Check hitch frequently, making sure all fasteners and ball are properly tightened. If hitch is removed, plug all holes in trunk pan or other body panels to prevent entry of water and exhaust fumes. A hitch or ball which has been damaged should be removed and replaced. Observe safety precautions when working beneath a vehicle and wear eye protection. Follow car maker's specs for maximum trailer weight and tongue weight. Do not cut access or attachment holes with a torch.